

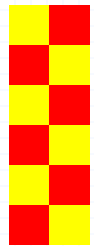

SCDF

The Life Saving Force

... for a safer Singapore



FSM Briefing 2022: Other Updates to FSMs

28 July 2022

*MAJ Neo Jin Xiang, Senior Staff Officer
Fire Safety Department, SCDF*



Scope

1. Resumption of Fire Drill
2. Obstruction to emergency exits
3. PWD holding areas
4. KED fire safety
5. Implementation of Emergency Preparedness (EP) measures



1. Resumption of Fire Drill

- FSMs and building owners were advised to conduct table-top exercises instead of physical fire drills in 2020 and 2021 due to COVID-19 restrictions
- In tandem with the easing of community Safe Management Measures (SMMs), physical fire drills have since resumed on **1 April 2022**
- The industry has been updated on the resumption of 2 physical fire drills for 2022 via the following channels -
 - a. Email blast to FSMs
 - b. Update on SCDF website
 - c. Update to strategic partners (FSMAS, NFEC and A-CERTS)



2. Obstruction to Emergency Exits

- With the easing of community Safe Management Measures (SMMs), most premises do not require SafeEntry check-ins
- FSMs should ensure that emergency exits of premises are not obstructed
- FSMs should also check that all EM-locked exits are in working order

TODAY Voices MENU ▾ 🔍

Entry restrictions at malls: Is fire safety at stake?

By DAVID KWOK NG KAN



David Kwok Ng Kan
A locked entrance at People's Park Centre on Aug 18, 2020.

Published 20 AUGUST, 2020

Example of locked exits that impede evacuation

Source: www.straitstimes.com



3. Person with Disabilities (PWD) Holding Areas

- Fire Code - 2.4 SPECIAL REQUIREMENTS FOR PERSON WITH DISABILITIES (PWD), cl 2.4.1 to cl 2.4.7

Purpose

- A PWD Holding Point shall be provided on all storeys, including all basement levels, except first storey or storey at grade level, for PWDs to safely wait for assistance in evacuation

Siting of PWD Holding Point

- There shall be at least two designated PWD Holding Points remotely positioned on every storey of a building except for a building designed with a single exit staircase allowed under this Code. The corridor serving as escape route shall have a minimum clear width of 1.2m
- The PWD Holding Point shall be kept free of obstruction and the escape routes shall be free from any obstacle that may cause undue delay to PWD during evacuation, e.g. raised thresholds or steps

Provision of Signage and means of Communications

- Shall be complied as according to cl 2.4.2 c and cl 2.4.3
- **Incorporate PWD Holding areas into ERP to assist evacuation of PWD**

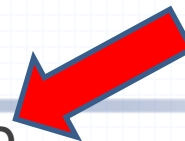

3. PWD Holding Areas

Example of incorporating PWD holding into ERP:

- Evacuate any PWD into PWD Holding area within a fire lift lobby
- Alert the FCC using the VCS
- Wait for rescue from CERT/ SCDF
- Fire Lift can be used for PWD evacuation

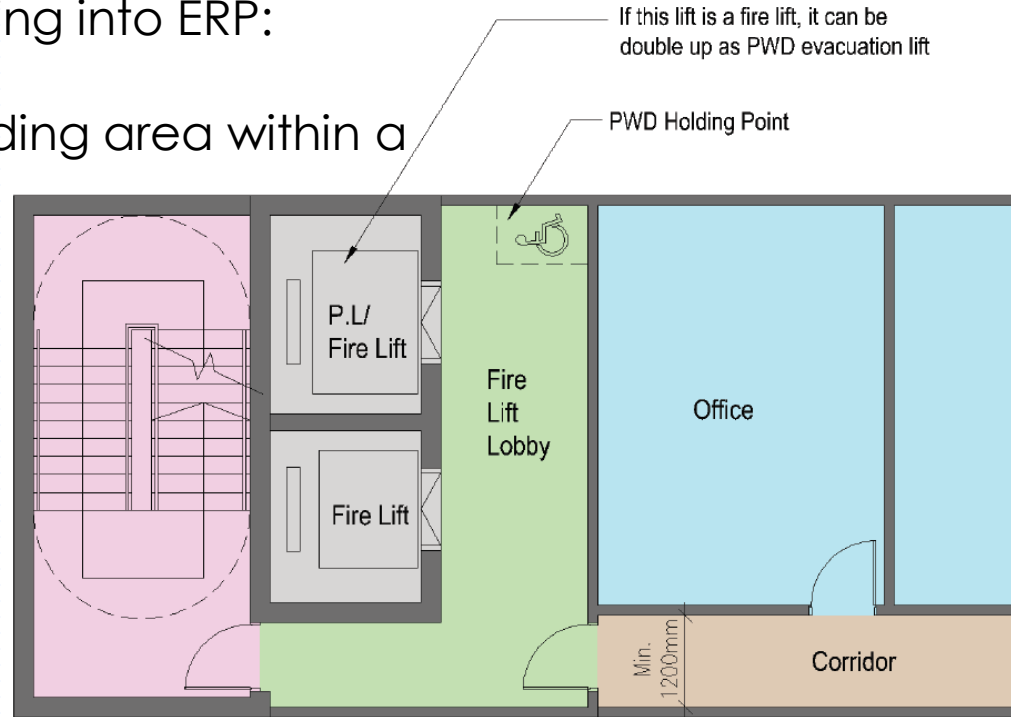

4. Kitchen Exhaust Duct (KED) Fire Safety

- ✓ What is the first thing to do during a kitchen stove fire?
- ✓ What is the most common causes of a kitchen fire?
- ✓ How do you prevent one?

Fires typically caused by **unattended cooking**, plus ignition of grease in the KEDs due to **lack of maintenance** (at least once annually)



4. Kitchen Exhaust Duct (KED) Fire Safety

- FSMs should look out for
 - ✓ Fire Safety Certificate (FSC) for the usage as F&B unit
 - ✓ FSC for KED/MV system in the unit
 - ✓ FSC for LPG Manifold system
- Maintenance of KED system of the unit
 - ✓ at least once annually,
 - ✓ maintenance report should provide photos depicting the work done
- LPG usage of eatery if >200kg, will require SCDF P&FM Storage license
- No LPG usage within air-conditioned eateries, open flame cooking strictly within kitchen area



4. Kitchen Exhaust Duct (KED) Fire Safety

- Wok fire can spread to whole coffee shop within minutes, need to have **sense of urgency to fight the fire**
- **Do not use water** to fight oil or grease-based fires, use **Dry Powder Fire Extinguisher** instead
- **Never** leave **cooking unattended**
- **KED cleaning** is money well spent; better than repairing the whole coffee shop, weeks of lost revenue



5. Implementation of Emergency Preparedness (EP) measures

Recap

- With the enactment of the amended FSA and SLs on **14 September 2020**, categories of premises such as schools, religious premises, workers' dormitories etc will be required to implement Emergency Preparedness (EP) measures
- These EP measures help to ensure a high level of readiness amongst building occupants to respond and evacuate in the event of a fire emergency, minimizing potential fatalities and casualties
- FSMs and building owners play a key role in ensuring that EP measures are maintained



5. Implementation of Emergency Preparedness (EP) measures

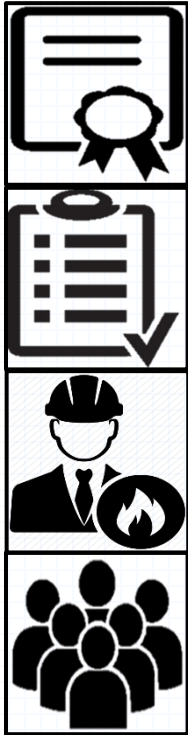

- **Fire Certificate (FC)**
 - ✓ Ensure maintenance of fire protection systems
- **Emergency Response Plan (ERP)**
 - ✓ Contingency plan for fire and related emergencies
- **Fire Safety Manager (FSM)**
 - ✓ Ensure compliance with fire safety requirements in ERP
 - ✓ Conduct regular checks to remove fire hazards
 - ✓ Conduct fire drills for occupants twice a year
- **Company Emergency Response Team (CERT)**
 - ✓ Assist owner/occupier to carry out duties in ERP
 - ✓ Conduct initial fire-fighting (incipient fire) before SCDF arrival
 - ✓ Provide assistance as may be required by SCDF





5. Implementation of Emergency Preparedness (EP) measures

Fire Certificate (FC)

- The FC scheme ensures that fire protection systems are properly maintained at the premises
- Renewal of FC has to be done on an annual basis
- Under Section 25(2) of the Fire Safety (Building and Pipeline Fire Safety) Regulations, *“an application for the renewal of a fire certificate shall be made at least 2 months before the expiry of the fire certificate.”*
- FSMs are advised to remind the building owners to carry out the FC renewal application timely





5. Implementation of Emergency Preparedness (EP) measures

Fire Certificate (FC)

- Submission of FC renewal is to be done via SCDF e-services
- Premises that have failed to obtain the Fire Certificate timely will be liable to Section 35(2) of the Fire Safety Act for occupying premises without a valid Fire Certificate

The screenshot shows the SCDF E-Services website. On the left is a navigation menu with the following items: Home Fire Alarm Device (HFAD), Plans and Consultations, Permits and Certifications, Petroleum and Flammable Material Licences, Emergency Response Plan, Company Emergency Response Team (CERT), Amusement Rides Approval, Downloads, E-Services (highlighted in blue with a right-pointing arrow), and Useful Links. The main content area is titled "E-Services" and contains a notice: "Please be informed that the SCDF e-Services have moved to a new URL. Please follow the links in the e-Services page and update your bookmarks accordingly." Below the notice, it states: "In here, you will be able to use our E-Services to address your needs with respect to Fire Safety Approval, Fire Safety Licensing and Fire Safety Enforcement as listed below." Further down, it says: "We hope you have a good time in using our E-Services. In the event you have encountered any problems in using our E-Services, do not hesitate to feedback or contact us by clicking on 'Contact Info' for the list of contact persons with their e-mail address and contact numbers." At the bottom of the main content area, there is a list of services: "Fire Safety Plan Approval", "Fire Safety Permit and Certification", "Shelter Waiver Approval", and "Fire Safety Licensing and Enforcement". Each item has a downward-pointing arrow icon. A hand cursor is pointing to the arrow for "Fire Safety Permit and Certification", and a callout box next to it says "Select this to drop down".





5. Implementation of Emergency Preparedness (EP) measures

Company Emergency Response Team (CERT)

- As part of the FSM duties, FSMs are required to “*train, coordinate and supervise the Company Emergency Response Team for the premises in first-aid, fire-fighting and evacuation in the event of fire or other related emergencies.*”

Site Main Controller



Site Incident Controller



Emergency Response Team Members



Anybody can be a CERT member, regardless of age or gender.



Thank you

